



Hvorfor bo i et innovativt økosystem

**Facility Director, Arla Foods
Hardy Kjærgaard**

**m3 Manager, Søren Madsen
Agro Food Park**

14. Marts 2017





Arla Innovation Center

Hvor skal vi placere vores bygninger ?

VIDEN

HVOR BOR OG UDDANNES NYE
MEDARBEJDERE

INFRASTRUKTUR

KONE / MAND JOB

INTERNATIONALT UDDANNELSESMILJØ

KULTURELLE UDBUD

DRIFTSSTEDER

SMUKKE OMGIVELSER

FRITIDSAKTIVITETER

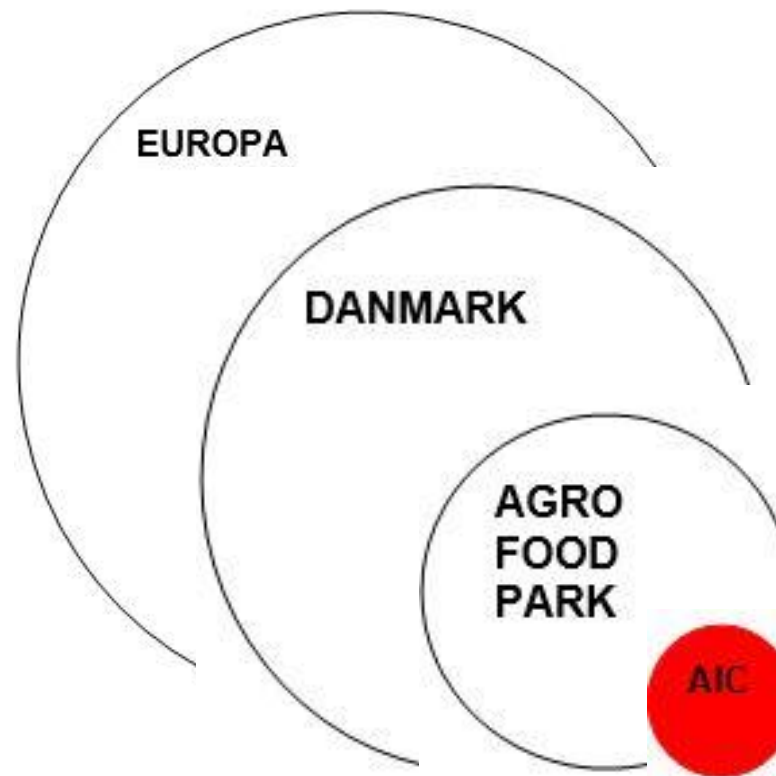

Agro Food Park





Hvad skal vores bygninger indeholde ?

UDVIDELSER

BEDSTE PLACERING

ÅBENHED

PILOT PLANT OG LABORATORIER

SELVFORSYENDE

SIGNALVÆRDI

FLEKSIBILITET

EJE eller LEJE

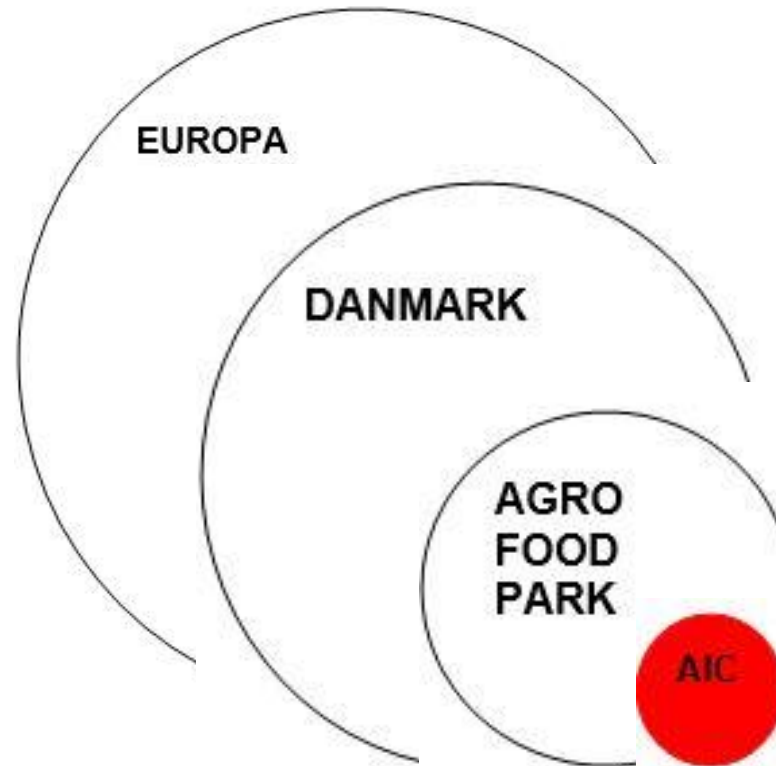



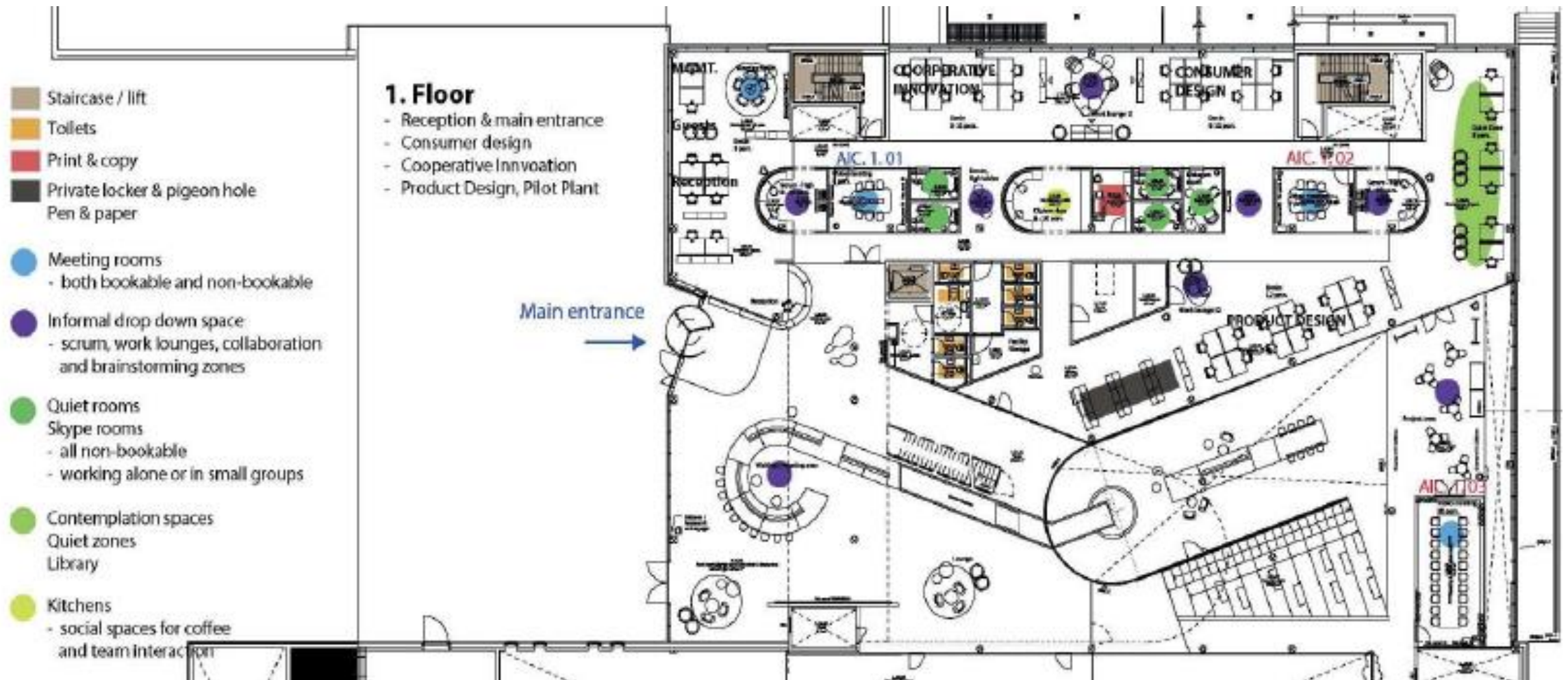



Hvordan skal vi indrette os ?

Åbent og imødekommende
Mangfoldig indretning
Fleksibelt
Transparent og synlighed
Intelligente AV-løsninger
Kunde og forbruger i centrum
FM serviceniveau
Smukke omgivelser





Indretning – mangfoldighed

Standard workstations

Meeting rooms

Quiet zones for concentrating

Presentation suites

Collaboration zones

Informal drop down space

Brainstorming spaces

Canteen

Meet and greet spaces (reception area)

Project rooms

Quiet rooms for private conversations

Social spaces for coffee and team interaction

Video and tele conferencing facilities

Contemplation spaces

Tables for spreading out papers

Outdoor markings for walk-and-talks







New ways of working

Working (alone) quietly/ concentrated

- Quiet rooms
- Quiet zones
- Library
- Work lounges

Working together / concentrated

- Quiet rooms
- Meeting rooms
- Project rooms

Working alone/together

- Office areas by
standard desks
- Informal drop down
spaces

Working together

- Meeting rooms
- Work lounges
- Kitchens
- Canteen
- Scrum areas
- And other informal
drop down spaces



Tak for opmærksomheden!



